



EMERGENCY GAS SHUT OFF

If an emergency occurs, but you do not experience flu-like symptoms or smell or hear leaking gas, then you probably do not need to shut off your gas. Doing so may interrupt your service unnecessarily.

However, if you are experiencing flu-like symptoms without a fever, are in doubt, or smell or hear leaking gas, then:



DO NOT:

- Switch anything on or off, such as lights, electrical switches, garage door openers, or vehicles.
- Use e-cigarettes, smoke, lighters, matches or other open flames.
- Use a telephone of any type, including cell phones.
- Return for personal items.



DO:

- Immediately leave the house or building.
- From a safe location, call Great Plains Natural Gas at 877-267-4764 and call 911.
- If it is safe to do so, shut off the gas meter following the instructions on the other side of this card.
- Once the gas is off, for your safety, LEAVE IT OFF until a Great Plains Natural Gas technician can check out the system to ensure it is safe and operable before turning it back on.

To be fully prepared for an emergency, know where your gas meter is located and how to shut off the natural gas service to your home.

The following are examples of emergencies; however, it is not a complete list:

- Fire in the home or near the meter.
- Earthquakes with enough magnitude to displace equipment.
- Floods.
- Wind damage.
- Carbon monoxide (flu-like) symptoms.
- Gas odors.

HOW TO SHUT OFF A GAS METER

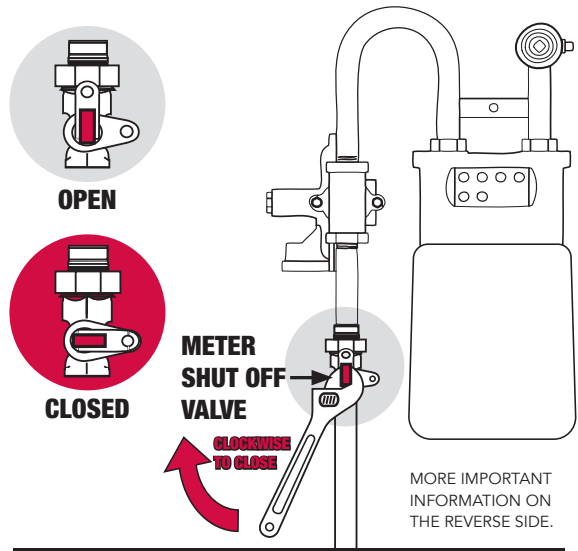

- ▶ Locate the meter shut-off valve (pictured) on the gas supply pipe coming out of the ground.
- ▶ Use a long-handled wrench to turn the valve one-quarter turn so that the lever is crosswise to the pipe (see diagram).
- ▶ Once the valve is off, **LEAVE IT OFF** until a qualified Great Plains Natural Gas technician can check out the system.

**FOR ALL EMERGENCIES CALL,
877-267-4764**



www.gpng.com

GREAT PLAINS
NATURAL GAS CO.

A Division of Montana-Dakota Utilities Co.

In the Community to Serve®